



VENTURI SYSTEMS

LAFFERTY TIMED ENTRYWAY FOAM SANITIZERS apply a layer of rich foam sanitizer to entryway floors to prevent cross contamination from foot or wheeled traffic. These are water-driven venturi systems that accurately dilute chemical concentrates to required ratios. A container of chemical concentrate is required at each entryway.

These systems are offered in 120V versions, for use in the United States, and 24V versions, for use outside the United States, and with a choice of three methods of activation:

- **Timed** — timer-controlled application at regular intervals
- **Push Button (Single Shot)** — manual activation of a single, timed application cycle
- **Photocell** — motion activation of a single, timed application cycle

TIMED ENTRYWAY FOAM SANITIZERS • For Employee Walk Doors (3 ft. wide) and Double Doors (6 ft. wide)

REQUIRES: 35-125 PSI WATER, CHEMICAL CONCENTRATE, COMPRESSED AIR, ELECTRICITY

- For employee walk doors and double doors
- Venturi foamer draws chemical concentrate and dilutes it to the required ratio
- Dual model for 2 adjacent, 3 ft. doors (976505)
- Optional additional chemical pick-up for adding foaming agent
- 24 Volt models, for use outside the USA, require a locally-sourced step-down transformer to provide 24 VAC power to the controller

Choice of three activation methods:

- **Timed (Standard)** – A recycle timer controls application of foam at regular, timed intervals —up to 1 minute foaming and up to 1 hour off. Timed models are used in moderate to high traffic areas
- **Push Button – Single Shot** (Upgrade available at time of order only) – Activated by a remote push button, the units must be physically activated each time foam is required. For use in low traffic areas
- **Photocell** (Upgrade available at time of order only) – These units supply foam to the entryway floor, “on demand,” for a set amount of time. The multi-function timer also controls the minimum amount of time between activations, preventing costly over-application when traffic is heavy

Includes

- NEMA rated control box
- Machined polypropylene foamer body
- Stainless steel mounting plate
- Color-coded metering tips (20)
- Metering tip driver
- 10' discharge hose with Lafferty Spreader nozzle



UPGRADES available at time of order



Spreader nozzle

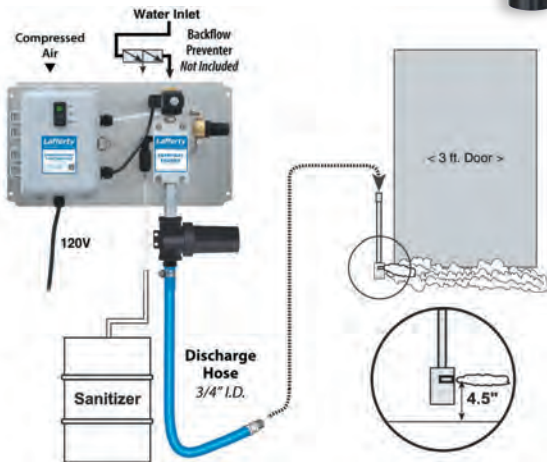

Model # Description
120 Volt models for use in the USA

For Walk Doors (3 ft.)	
976500	Timed Entryway Foam Sanitizer
976505	Timed Dual Entryway Foam Sanitizer

For Double Doors (6 ft.)

976530	Timed Entryway MV Foam Sanitizer
--------	----------------------------------

Options / Upgrades (Available at Time of Order):

976012	Entryway Dual Chemical Pick-up Assembly
976001PB	Push Button Upgrade
976001EE	Photocell Upgrade
976001SL	Anticipatory Strobe Upgrade

Model # Description
24 Volt models for use outside the USA

For Walk Doors (3 ft.)	
976500-24V	Timed Entryway Foam Sanitizer - 24VAC
976505-24V	Timed Dual Entryway Foam Sanitizer - 24VAC

For Double Doors (6 ft.)

976530-24V	Timed Entryway MV Foam Sanitizer - 24VAC
------------	--

Options / Upgrades (Available at Time of Order):

976012	Entryway Dual Chemical Pick-up Assembly
976001PB-24V	Push Button Upgrade
976001EE-24V	Photocell Upgrade



VENTURI SYSTEMS

LAFFERTY TIMED ENTRYWAY HV FOAM SANITIZERS apply a layer of rich foam sanitizer to wide entryway floors to prevent cross contamination from foot or wheeled traffic. These are water-driven venturi systems that accurately dilute chemical concentrates to required ratios. A container of chemical concentrate is required at each entryway.

These systems are offered in 120V versions, for use in the United States, and 24V versions, for use outside the United States, and with a choice of three methods of activation:

- **Timed** — timer-controlled application at regular intervals
- **Push Button (Single Shot)** — manual activation of a single, timed application cycle
- **Photocell** — motion activation of a single, timed application cycle

TIMED ENTRYWAY HV FOAM SANITIZERS • For Wide / Overhead Doorways (8-16 ft. wide)

REQUIRES: 35-125 PSI WATER, CHEMICAL CONCENTRATE, COMPRESSED AIR, ELECTRICITY

- For wide / overhead doorways
- Venturi foamer draws chemical concentrate and dilutes it to the required ratio
- Optional additional chemical pick-up for adding foaming agent
- 24 Volt models, for use outside the USA, require a locally-sourced step-down transformer to provide 24 VAC power to the controller

Choice of three activation methods:

- **Timed (Standard)** – A recycle timer controls application of foam at regular, timed intervals —up to 1 minute foaming and up to 1 hour off. For use in moderate to high traffic areas
- **Push Button – Single Shot** (*Upgrade available at time of order only*) – Activated by a remote push button, the units must be physically activated each time foam is required. For use in low traffic areas
- **Photocell** (*Upgrade available at time of order only*) – These units supply foam to the entryway floor, “on demand,” for a set amount of time. The multi-function timer also controls the minimum amount of time between activations, preventing costly over-application when traffic is heavy

Includes

- NEMA rated control box
- Machined polypropylene foamer body
- Stainless steel mounting plate
- Color-coded metering tips (20)
- Metering tip driver
- 10' discharge hose and 2 Lafferty *Spreader* nozzles (Both must be used)



UPGRADES available at time of order

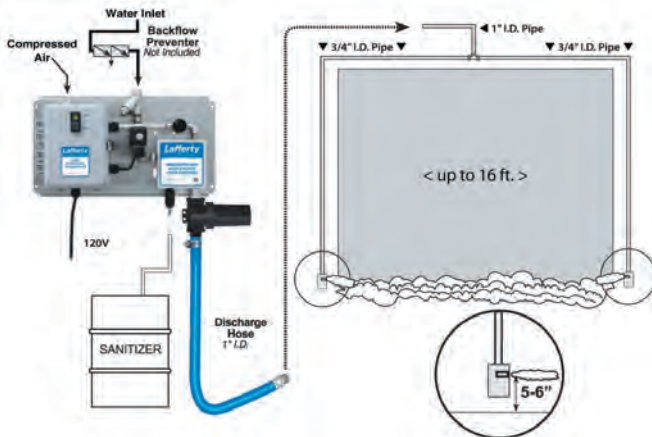

Model #	Description
120 Volt models for use in the USA	
For Wide / Overhead Doors (8-16 ft.)	
976560	Timed Entryway HV Foam Sanitizer

Option / Upgrades (Available at Time of Order):	
976013	HV Entryway Dual Chemical Pick-up Assembly
976001PB	Push Button Upgrade
976001EE	Photocell Upgrade
976001SL	Anticipatory Strobe Upgrade

Model #	Description
24 Volt models for use outside the USA	
For Wide / Overhead Doors (8-16 ft.)	
976560-24V	Timed Entryway HV Foam Sanitizer - 24VAC

Option:	
976013	HV Entryway Dual Chemical Pick-up Assembly
976001PB-24V	Push Button Upgrade
976001EE-24V	Photocell Upgrade



VENTURI SYSTEMS

- Timed Controller
- PLC JAZZ Controller

LAFFERTY ENTRYWAY SATELLITE SYSTEMS use one **Entryway Satellite Controller** to uniformly regulate up to 10 **Satellite Entryway Foam Sanitizers** in applying a layer of rich foam sanitizer to entryway floors to prevent cross contamination from foot or wheeled traffic. These are water-driven venturi systems that accurately dilute chemical concentrates to required ratios. A container of chemical concentrate is required at each entryway.

Satellite Foam Sanitizers are activated and operated by compressed air from the Satellite Controller — no electrical connection is required at the entryway location

ENTRYWAY SATELLITE CONTROLLERS

REQUIRES: ELECTRICITY, COMPRESSED AIR

Timed Entryway Satellite Controller

- Provides regular application cycles
- Controls up to 10 satellite foamers — All foamers activate and deactivate at the same time
- Adjustable timer controls the application (on/off) and delay (off) cycles
- The same cycle settings repeat until the Controller is turned off.
- Manual Override switch provides instant foam when needed
- 24 Volt models, for use outside the USA, require a locally-sourced step-down transformer to provide 24 VAC power to the controller

PLC Jazz Entryway Satellite Controller

- Allows variable settings for holidays, weekly or seasonal changes in hours of operation and peak and off-peak traffic demands.
- Controls up to 10 satellite foamers — All foamers **operate in accordance with a single set of programmed commands**
- Manual override for on and off cycles, without affecting the programming
- Features straightforward, menu-driven programming options
- 24 Volt models, for use outside the USA, require a locally-sourced step-down transformer to provide 24 VAC power to the controller

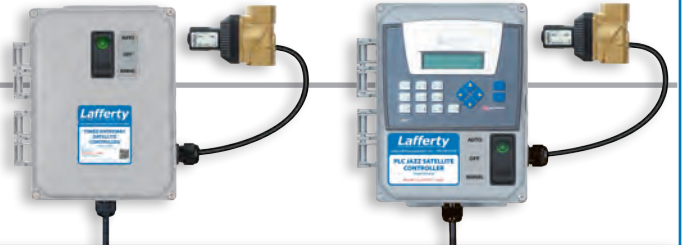

Model #	Description
120 Volt models for use in the USA	
976625	Timed Entryway Satellite Controller
976630	PLC Jazz Entryway Satellite Controller
24 Volt models for use outside the USA	
976625-24V	Timed Entryway Satellite Controller - 24VAC
976630-24V	PLC Jazz Entryway Satellite Controller - 24VAC

These controllers work with any combination of satellite units:

- *Satellite Foam (Walk Door)*
- *Satellite MV Foam (Double Door)*
- *Satellite HV Foam (Wide / Overhead Door).*

SATELLITE ENTRYWAY FOAM SANITIZERS

REQUIRES: 35-125 PSI WATER, CHEMICAL CONCENTRATE (& COMPRESSED AIR FROM CONTROLLER)

- For employee walk doors (3 ft. wide) and double doors (6 ft. wide)
- Venturi foamer draws chemical concentrate and dilutes it to the required ratio
- Optional dual chemical pick-up assembly for adding foaming agent

Includes

- NEMA rated control box
- Machined polypropylene foamer body
- Stainless steel mounting plate
- Color-coded metering tips (20)
- Metering tip driver
- 10' discharge hose with Lafferty *Spreader* nozzle



Model #	Description
For Walk Doors (3 ft.)	
976650	Satellite Entryway Foam Sanitizer
For Double Doors (6 ft.)	
976651	Satellite Entryway MV Foam Sanitizer
Option:	
976012	Entryway Dual Chemical Pick-up Assembly

Satellite Foamers within 300 ft. of the controller require a minimum 1/2" air header from the controller to the satellite. Air @ 100 PSI.
 Satellite Foamers 300-400 ft. from the controller require a minimum 3/4" air header from the controller to the satellite. Air @ 100 PSI.

SATELLITE ENTRYWAY HV FOAM SANITIZERS (for Wide/Overhead Doorways (8-16 ft. wide))

REQUIRES: 35-125 PSI WATER, CHEMICAL CONCENTRATE (& COMPRESSED AIR FROM CONTROLLER)

- For wide / overhead doorways
- Venturi foamer draws chemical concentrate and dilutes it to the required ratio
- Optional dual chemical pick-up assembly for adding foaming agent

Includes

- NEMA rated control box
- Machined polypropylene foamer body
- Stainless steel mounting plate
- Color-coded metering tips (20)
- Metering tip driver
- 10' discharge hose and 2 Lafferty *Spreader* nozzles (Both must be used)



Model #	Description
For Wide / Overhead Doors (8-16 ft.)	
976652	Satellite Entryway HV Foam Sanitizer
Option:	
976013	HV Entryway Dual Chemical Pick-up Assembly

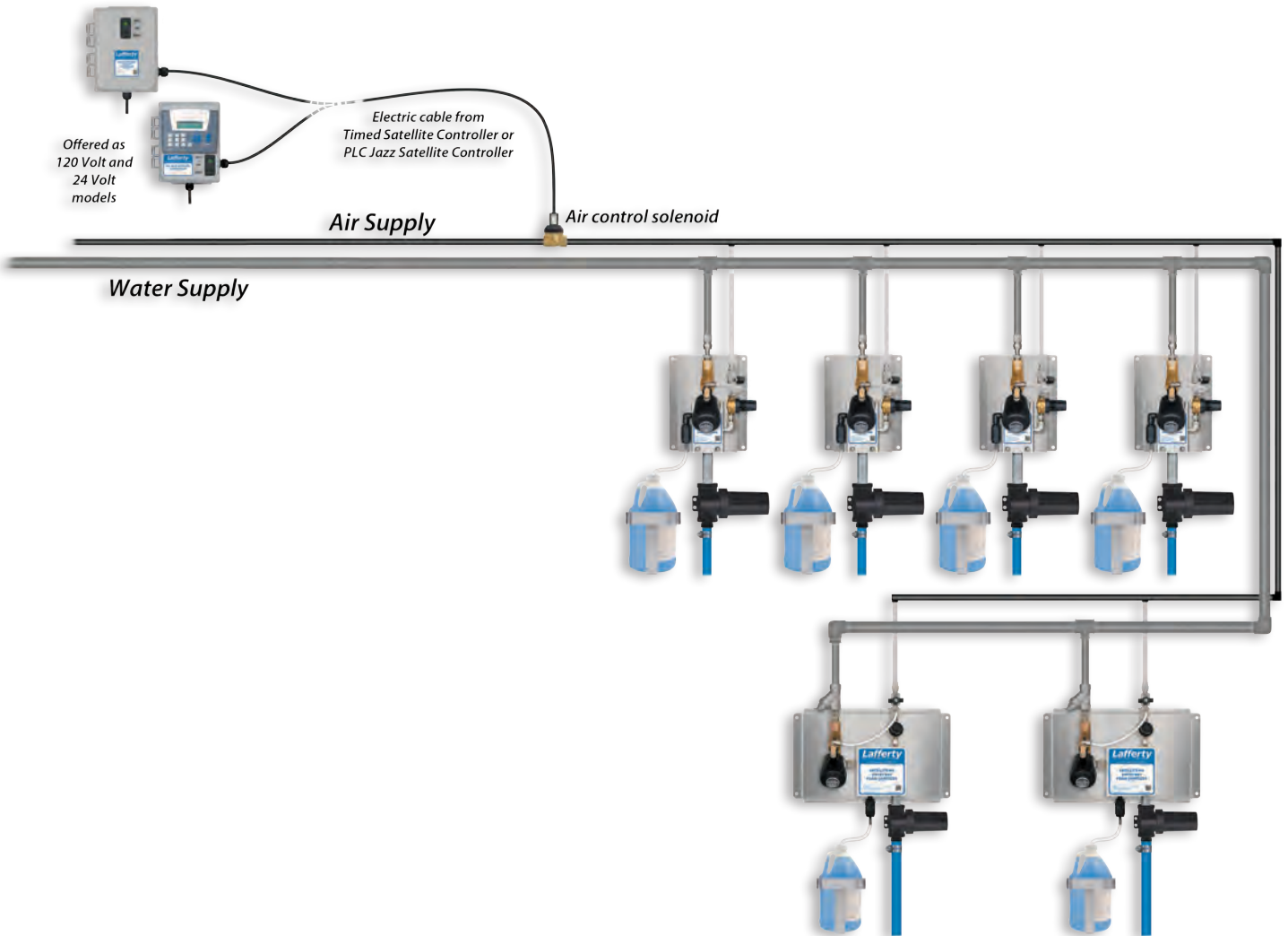



PUMP FED SYSTEMS

LAFFERTY TIMED PUMP FED ENTRYWAY FOAM SANITIZERS apply a layer of rich foam sanitizer to entryway floors to prevent cross contamination from foot or wheeled traffic. These pump fed systems are fed ready-to-use (RTU) chemical solution from a central chemical feed system, eliminating the presence of concentrated chemical at the entryway location.

These systems are offered in 120V versions, for use in the United States, and 24V versions, for use outside the United States, and with a choice of three methods of activation:

- **Timed** — timer-controlled application at regular intervals
- **Push Button (Single Shot)** — manual activation of a single, timed application cycle
- **Photocell** — motion activation of a single, timed application cycle

TIMED PUMP FED ENTRYWAY FOAM SANITIZERS

REQUIRES: RTU CHEMICAL SOLUTION @ 35 TO 75 PSI, COMPRESSED AIR, ELECTRICITY

- For employee walk doors and double doors and wide/overhead doors 8' to 16' wide
- Units are fed RTU chemical solution from a central chemical feed system.

Choice of three activation methods:

- **Timed (Standard)** – A recycle timer controls application of foam at regular, timed intervals —up to 1 minute foaming and up to 1 hour off. Timed models are used in moderate to high traffic areas
- **Push Button – Single Shot** (*Upgrade available at time of order only*) – Activated by a remote push button, the units must be physically activated each time foam is required. Push Button (Single Shot) models are used in low traffic areas
- **Photocell** (*Upgrade available at time of order only*) – These units supply foam to the entryway floor, “on demand,” for a set amount of time. The multi-function timer also controls the minimum amount of time between activations, preventing costly over-application when traffic is heavy

Includes

- NEMA rated control box
- Machined polypropylene foamer body
- Stainless steel mounting plate
- Stainless steel solution solenoid
- 10' discharge hose with Lafferty *Spreader* nozzle(s) — *XV models include two nozzles*

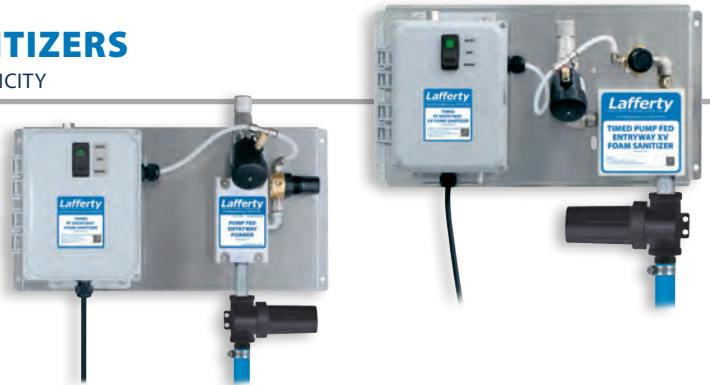

Model #	Description
120 Volt models for use in the USA	
For Walk Doors (3 ft.)	
976250	Timed PF Entryway Foam Sanitizer
For Double Doors (6 ft.)	
976256	Timed PF Entryway MV Foam Sanitizer
For Wide / Overhead Doors (8-16 ft.)	
976260	Timed PF Entryway XV Foam Sanitizer
Upgrades (Available at Time of Order)	
976003PB	Push Button Upgrade for PF Entryway System
976003EE	Photocell Upgrade for PF Entryway System

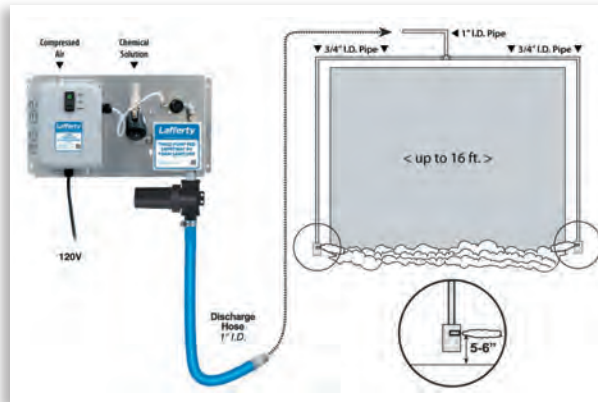
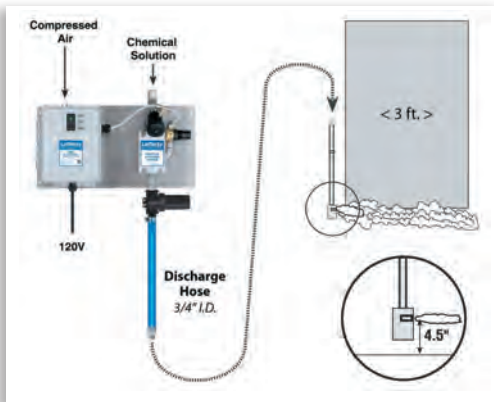



Sandpiper Pump

1/2" or 1" AODD
Santoprene Diaphragm
Teflon Optional

LAFFERTY CENTRAL CHEMICAL PUMPING SYSTEMS deliver diluted chemical solution to multiple Lafferty Pump Fed Entryway Foam Sanitizers. A compressed air operated double diaphragm pump delivers diluted chemical to these units from a Lafferty High Flow Level Master System or from a holding tank.

Choice of two flow rates, available with diaphragm upgrades to suit chemical compatibility needs.

These pumping systems are compatible with all the Pump Fed Entryway Systems shown on pages 10–13 and High Flow Level Master Systems on pages 15 and 17.

COMPRESSED AIR DRIVEN TRANSFER / PUMPING SYSTEMS

REQUIRES: COMPRESSED AIR, CHEMICAL CONCENTRATE OR RTU CHEMICAL SOLUTION

- A compressed air-operated double diaphragm pump transfers chemical concentrate or diluted ready-to-use (RTU) chemical solution from a bulk container to any other container.
- Choice of two flow rates — up to 12 or 40 gpm when used as transfer system; lower for more viscous liquids
- Polypropylene pump with Santoprene diaphragms
- Optional Teflon diaphragm available
- *These pumping systems can also be used in Central Chemical feed Systems for delivering diluted RTU chemical solution to Lafferty Pump Fed Sanitizers, Foamers and combination Hose Drop Stations. (See Catalog 5)*

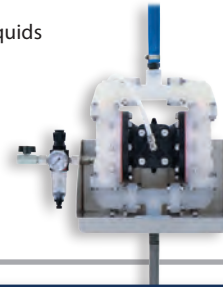

1/2" Transfer / Mini-Central Pumping System

- Complete system mounted on a heavy duty stainless steel mounting bracket.
- Portable models feature heavy duty stainless steel carts and a choice of trigger gun or ball valve.

REQUIREMENTS / SPECIFICATIONS

Compressed Air	up to	16 cfm	453.1 lpm
Output Volume (<i>according to intended use</i>)			
Transfer System	up to	12.0 gpm	45.4 lpm
Pumping System	up to	9.0 gpm	34.1 lpm

Model # Description

Up to 12 gallons per minute

919050	1/2" Transfer / Mini-Central Pumping System
941940	Portable 40 Gallon Freedom XV Transfer System
710919	Teflon Diaphragm Upgrade for 1/2" Air Pump

Larger capacity and custom systems available on request

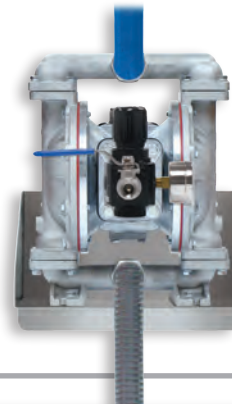

1" Transfer / Central Pumping System

- Complete system mounted on a heavy duty stainless steel mounting bracket.

REQUIREMENTS / SPECIFICATIONS

Compressed Air	up to	35 cfm	991 lpm
Output Volume (<i>according to intended use</i>)			
Transfer System	up to	40.0 gpm	151.4 lpm
Pumping System	up to	25.0 gpm	94.6 lpm

Model # Description

Up to 40 gallons per minute

919060SS	1" Transfer / Central Pump System, Stainless Steel / Santoprene Diaphragm
710943	Teflon Diaphragm upgrade for 1" SS Air Pump



PUMP FED SYSTEMS
 • Timed Controller
 • PLC JAZZ Controller

LAFFERTY PUMP FED ENTRYWAY SATELLITE SYSTEMS use one **Entryway Satellite Controller** to uniformly regulate up to 10 **Satellite Pump Fed Entryway Foam Sanitizers** in applying a layer of rich foam sanitizer to entryway floors to prevent cross contamination from foot or wheeled traffic. These pump fed systems are fed ready-to-use (RTU) chemical solution from a central chemical feed system, eliminating the presence of concentrated chemical at the entryway location.

Satellite Foam Sanitizers are activated and operated by compressed air from the Satellite Controller — no electrical connection is required at the entryway location

ENTRYWAY SATELLITE CONTROLLERS

REQUIRES: ELECTRICITY, COMPRESSED AIR

Timed Entryway Satellite Controller

- Provides regular application cycles
- Controls up to 10 satellite foamers — All foamers activate and deactivate at the same time
- Adjustable timer controls the application (on/off) and delay (off) cycles
- The same cycle settings repeat until the Controller is turned off.
- Manual Override switch provides instant foam when needed
- 24 Volt models, for use outside the USA, require a locally-sourced step-down transformer to provide 24 VAC power to the controller

PLC Jazz Entryway Satellite Controller

- Allows variable settings for holidays, weekly or seasonal changes in hours of operation and peak and off-peak traffic demands.
- Controls up to 10 satellite foamers — All foamers **operate in accordance with a single set of programmed commands**
- Manual override for on and off cycles, without affecting the programming
- Features straightforward, menu-driven programming options
- 24 Volt models, for use outside the USA, require a locally-sourced step-down transformer to provide 24 VAC power to the controller

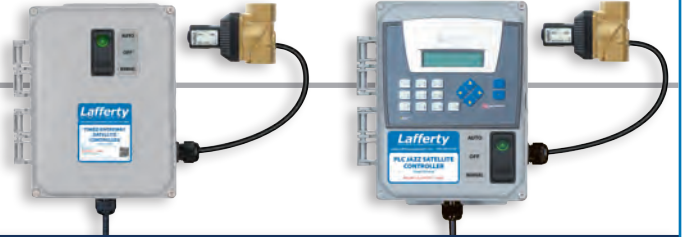

Model #	Description
120 Volt models for use in the USA	
976625	Timed Entryway Satellite Controller
976630	PLC Jazz Entryway Satellite Controller
24 Volt models for use outside the USA	
976625-24V	Timed Entryway Satellite Controller - 24VAC
976630-24V	PLC Jazz Entryway Satellite Controller - 24VAC

These controllers work with any combination of satellite units:

- Satellite PF Foam (Walk Door)
- Satellite PF MV Foam (Double Door)
- Satellite PF XV Foam (Wide / Overhead Door)

SATELLITE PF ENTRYWAY FOAM SANITIZERS • For Employee Walk Doors (3 ft. wide) and Double Doors (6 ft. wide)

REQUIRES: RTU CHEMICAL SOLUTION @ 35 TO 75 PSI (& COMPRESSED AIR FROM CONTROLLER)

- For employee walk doors and double doors
- Units are fed RTU chemical solution from a central chemical feed system

Includes

- NEMA rated control box
- Machined polypropylene foamer body
- Stainless steel mounting plate
- Stainless steel solution solenoid
- 10' discharge hose with Lafferty *Spreader* nozzle



Satellite Foamers within 300 ft. of the controller require a minimum 1/2" air header from the controller to the satellite. Air @ 100 PSI.
 Satellite Foamers 300-400 ft. from the controller require a minimum 3/4" air header from the controller to the satellite. Air @ 100 PSI.

Model #	Description
For Walk Doors (3 ft.)	
976640	Satellite PF Entryway Foam Sanitizer
For Double Doors (6 ft.)	
976641	Satellite PF Entryway MV Foam Sanitizer

SATELLITE PF ENTRYWAY XV FOAM SANITIZERS • For Wide/Overhead Doorways (8-16 ft. wide)

REQUIRES: RTU CHEMICAL SOLUTION @ 35 TO 75 PSI (& COMPRESSED AIR FROM CONTROLLER)

- For wide / overhead doors
- Units are fed RTU chemical solution from a central chemical feed system

Includes

- NEMA rated control box
- Machined polypropylene foamer body
- Stainless steel mounting plate
- Stainless steel solution solenoid
- 10' discharge hose and 2 Lafferty Spreader nozzles (Both must be used)



Model #	Description
For Wide / Overhead Doors (8-16 ft.)	
976642	Satellite PF Entryway XV Foam Sanitizer

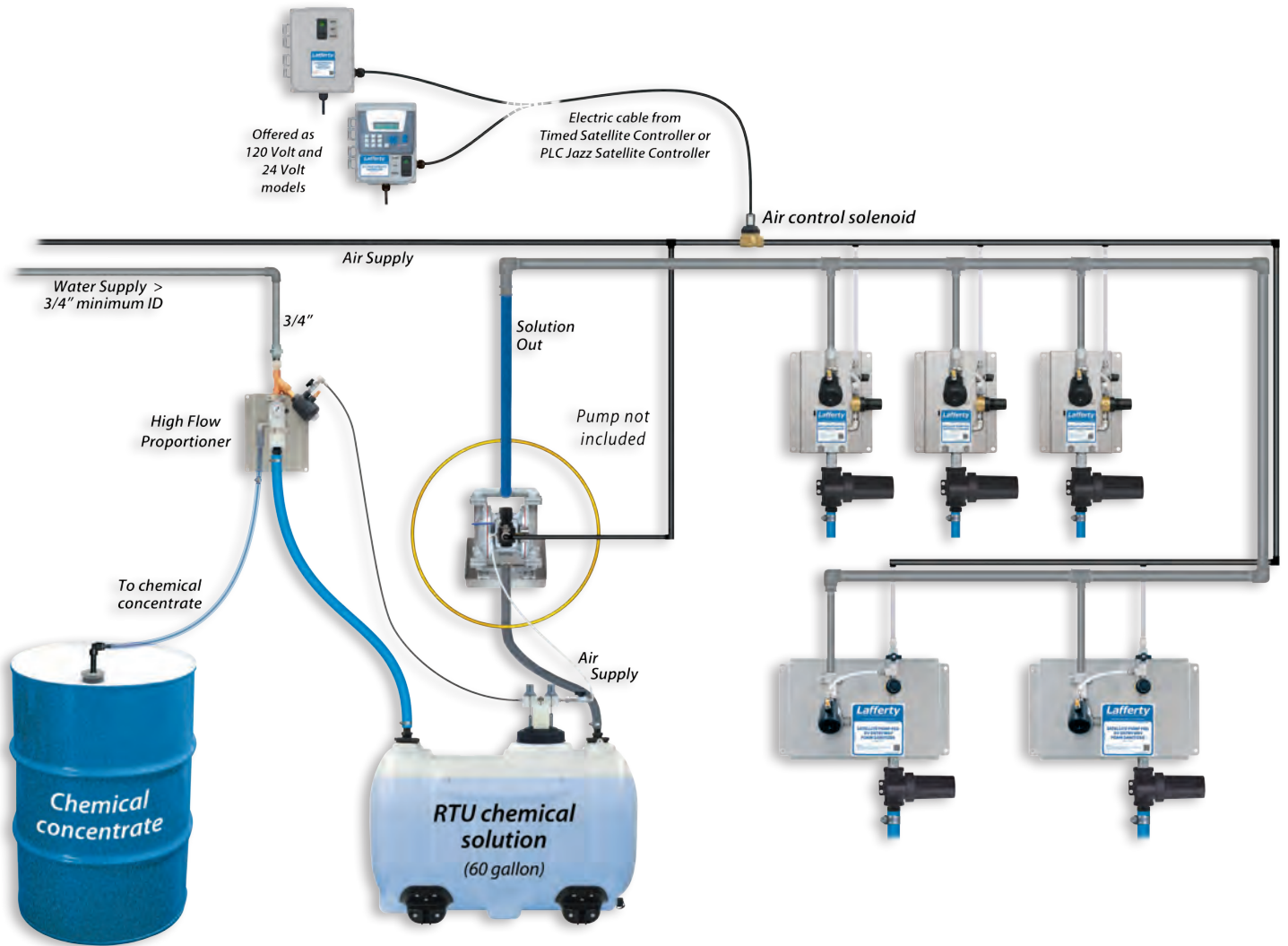



PUMP FED SYSTEMS
• VISION Controller

LAFFERTY VISION PUMP FED ENTRYWAY SATELLITE SYSTEMS use one Vision Entryway Satellite Controller to control up to 6 zones of up to 10 Vision Satellite Pump Fed Entryway Foam Sanitizers in applying a layer of rich foam sanitizer to entryway floors to prevent cross contamination from foot or wheeled traffic. These pump fed systems are fed ready-to-use (RTU) chemical solution from a central chemical feed system, eliminating the presence of concentrated chemical at the entryway location.

Vision Satellite Pump Fed Foam Sanitizers are activated by compressed air from the Vision Satellite Controller and operated by compressed air local to the satellite — No electrical connection is required at the entryway location.

VISION SATELLITE CONTROLLERS

REQUIRES: ELECTRICITY, COMPRESSED AIR

- Allows variable settings for holidays, weekly or seasonal changes in hours of operation and peak and off-peak traffic demands.
- Controls up to 6 satellite zones simultaneously with up to 10 satellite foamers per zone — Each zone is programmed independently.
- Manual override for on and off cycles, without affecting the programming
- Features straightforward, menu-driven programming options
- 24 Volt models, for use outside the USA, require a locally-sourced step-down transformer to provide 24 VAC power to the controller



These controllers work with any combination of satellite units:

- *Satellite PF Foam (Walk Door)*
- *Satellite PF MV Foam (Double Door)*
- *Satellite PF XV Foam (Wide / Overhead Door)*

Model #	Description
120 Volt models for use in the USA	
976710	6-Zone PLC Vision Satellite Controller
24 Volt models for use outside the USA	
976710-24V	6-Zone PLC Vision Satellite Controller - 24VAC

VISION SATELLITE PUMP FED ENTRYWAY FOAM SANITIZERS

• For Employee Walk Doors (3 ft. wide) and Double Doors (6 ft. wide)

REQUIRES: RTU CHEMICAL SOLUTION @ 35-75 PSI, COMPRESSED AIR

- For employee walk doors and double doors
- Units are fed RTU chemical solution from a central chemical feed system
- Each Vision satellite foamer requires a separate direct connection to compressed air for foamer operation.

Includes

- NEMA rated control box
- Machined polypropylene foamer body
- Stainless steel mounting plate
- Stainless steel solution solenoid
- 10' discharge hose with Lafferty Spreader nozzle



Model #	Description
For Walk Doors (3 ft.)	
976724	Vision Satellite PF Entryway Foam Sanitizer
For Double Doors (6 ft.)	
976725	Vision Satellite PF Entryway MV Foam Sanitizer

VISION SATELLITE PUMP FED ENTRYWAY XV FOAM SANITIZERS

• For Wide / Overhead Doorways (8-16 ft. wide)

REQUIRES: RTU CHEMICAL SOLUTION @ 35 TO 75 PSI, COMPRESSED AIR

- For wide / overhead doors
- Units are fed RTU chemical solution from a central chemical feed system
- Each Vision Satellite foamer requires a separate direct connection to compressed air for foamer operation

Includes

- NEMA rated control box
- Machined polypropylene foamer body
- Stainless steel mounting plate
- Stainless steel solution solenoid
- 10' discharge hose and 2 Lafferty Spreader nozzles (Both must be used)



Model #	Description
For Wide / Overhead Doors (8-16 ft.)	
976726	Vision Satellite PF Entryway XV Foam Sanitizer

Lafferty Vision Entryway Satellite System - Pump Fed

This controller works with any combination of satellite units – Vision Satellite PF Foam (Walk Door), Vision Satellite PF MV Foam (Double Door) and Vision Satellite PF XV Foam (Wide/Overhead Door).

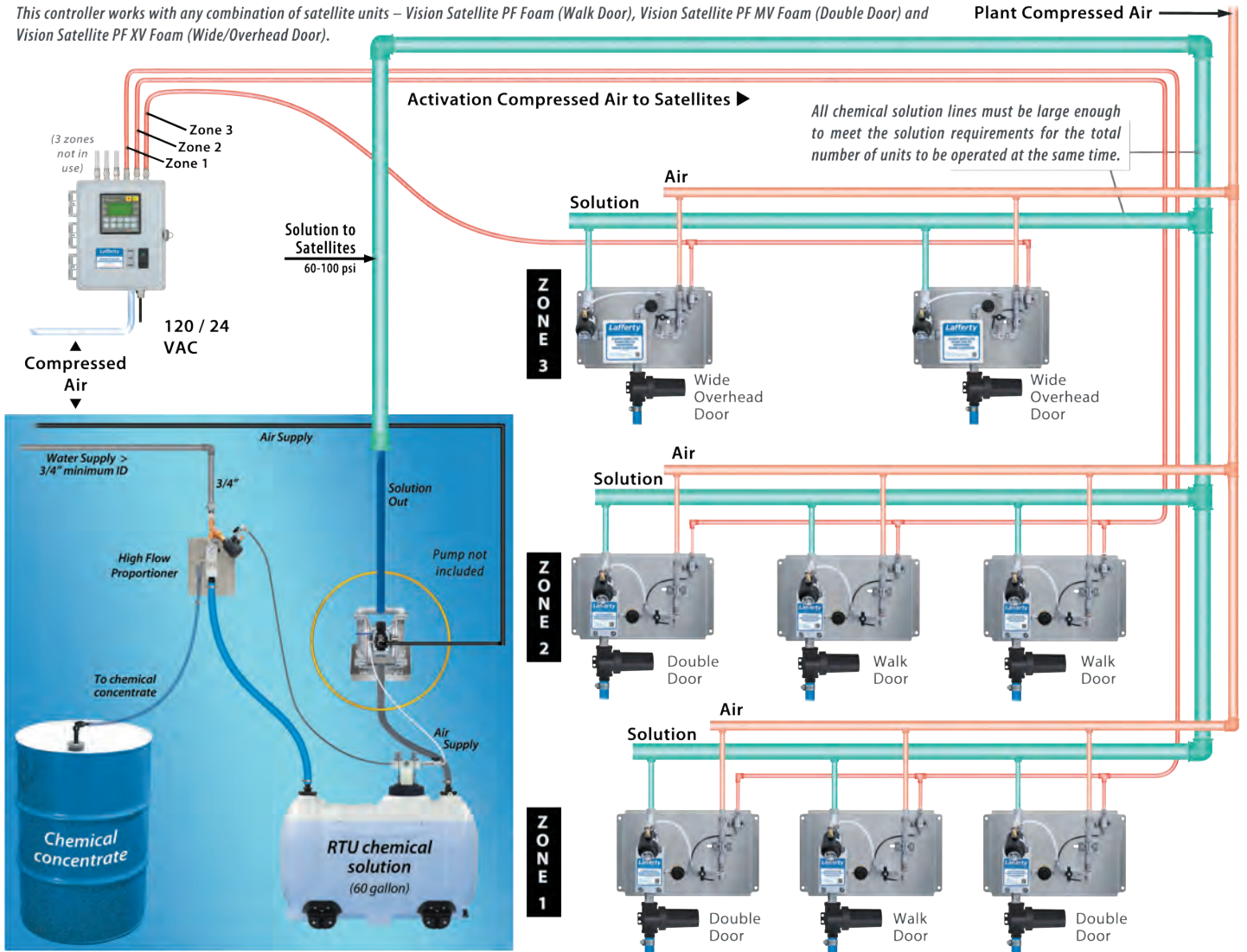



LAFFERTY LEVEL MASTER SYSTEMS are float valve operated proportioners, designed to maintain the desired level of ready-to-use (RTU) chemical solution in any reservoir. Lafferty's novel design incorporates machined, solid blocks of chemical-resistant polypropylene to reduce chemical leak points and enhance overall durability and function.

Standard Level Master Systems will produce RTU solution from one chemical concentrate. Available in two styles — bracket mount or lid mounted that are integrated with a tank lid to fit optional 7-gallon, 16-gallon, or 20-gallon tanks. (Lid-mounted High Flow Level Master Systems include a 60-gallon tank.)

Gemini Level Master Systems (see page 9) will separately proportion two chemicals before mixing the two solutions as they flow into the holding tank.

LEVEL MASTER™ SYSTEMS

REQUIRES: 25-80 PSI WATER

- Features a single water-driven venturi proportioner to dilute one chemical to the required ratio
- Single float design or dual float design for locations where preventing accidental overflow is critical. A second, smaller float provides fail-safe protection.
- Unsinkable solid polypropylene float suspended by a rigid "push rod" ensures smooth operation and prevents the float valve from sticking in the open position
- Chemical resistant wetted components ensure years of outstanding performance with minimal maintenance
- Downstream check valve prevents back-flow of liquid or vapor into the float valve to eliminate the potential for damage to internal components
- Industrial-strength design holds up in tough environments

Two styles

- Systems with heavy-duty stainless steel bracket for open tanks

SS Bracket clamps to the wall of an open tank

SSHM Bracket – horizontal mount – bolts to the top of a user-supplied tank

Systems integrated into a tank lid designed to fit a 7-gallon, 16-gallon or 20-gallon tank (*Can also be fitted to an optional 60-gallon tank.*)

REQUIREMENTS / SPECIFICATIONS

Water Pressure	25 - 80 PSI	1.7 - 5.5 bar
Water Flow Rate	@ 40 PSI	@ 2.8 bar
	2.4 gpm	9.1 lpm

Includes

- Water supply inlet strainer
- Water supply shut-off ball valve
- Machined polypropylene injector body
- Magnetic float valve (989303) — *two float valves, primary and fail-safe, for models 989304; 989308; 989312* — with solid polypropylene float(s) suspended by rigid CPVC push rod
- Stainless steel / Viton back-flow prevention check valve
- Color-coded metering tips (20) to set dilution ratios
- Metering tip driver
- Stainless steel bracket or plastic lid for a paired tank as indicated by model number (*Paired tank not included.*)

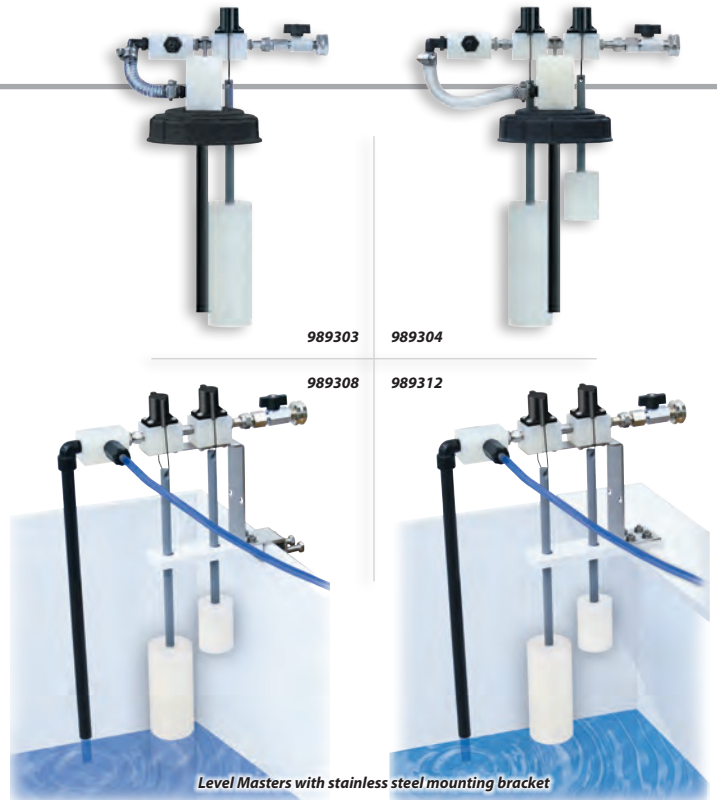
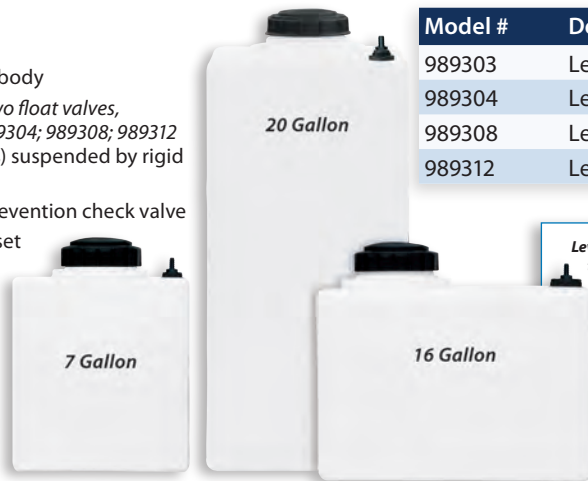

Level Masters with stainless steel mounting bracket

Model #	Description
989303	Level Master™ (Single Float - No Tank)
989304	Level Master™ (No Tank)
989308	Level Master™ with SS Bracket
989312	Level Master™ with SSHM Bracket

Level Master™ Tanks are heavy-duty HDPE tanks designed for use with a Level Master lid assembly (sold separately). Each tank includes inlet and discharge assemblies with hose barbs.

Level Master Tank Sizes (Specify When Ordering)
 7 Gallon# 709170
 16 Gallon# 709171
 20 Gallon# 709172

HIGH FLOW LEVEL MASTER SYSTEMS

REQUIRES: 35-125 PSI WATER, COMPRESSED AIR, CHEMICAL CONCENTRATE

- Float-valve-operated proportioners, designed to quickly replenish and maintain the desired level of ready-to-use (RTU) chemical solution in any reservoir.
- The float valve triggers an air-activated solenoid to start and stop the flow of water through the high volume venturi proportioners.
- Draws chemical concentrate from a user-supplied bulk container, dilutes the chemical to required ratio and delivers the solution to the 60 gallon tank (or a user-supplied day tank)
- Complete with hook-up connections for a compressed air-operated Lafferty Pumping System (or a user-supplied pumping system)

Choice of two flow rates.

Replenishes RTU solution at:

- 10.6 gpm @ 40 PSI – 989100; 989106
(Includes a single high flow venturi proportioner)
- 21.2 gpm @ 40 PSI – 989101; 989108
(Includes two high flow venturi proportioners)

Two styles

- Systems with heavy-duty stainless steel bracket for open tanks
 - *SS Bracket* clamps to the wall of an open tank
 - *SSHM Bracket* – horizontal mount – bolts to the top of a user-supplied tank
- Systems integrated with the lid of the included 60-gallon tank

REQUIREMENTS / SPECIFICATIONS

Compressed Air	<1 cfm	<28.3 lpm
Water Pressure	35 - 125 PSI	2.4 - 8.6 bar
Water Flow Rate	@ 40 PSI	@ 2.8 bar
989100 / 989106	10.6 gpm	40.1 lpm
989101 / 989108	21.2 gpm	80.3 lpm

Includes

- Auto on/off float valve, for continuous operation
- Manual on/off ball valve, for use when emptying solution reservoir
- Two magnetic float valves (primary and fail-safe) with solid polypropylene floats suspended by rigid CPVC push rods
- High flow proportioner(s) with machined polypropylene injector body
- Stainless steel Satellite Mixing Station mounting plate(s)
- Air-activated water solenoid
- 60 gallon, HDPE chemical tank with drain
- Color coded metering tips for up to 21 dilution ratios (1 set per proportioner)
- Metering tip driver

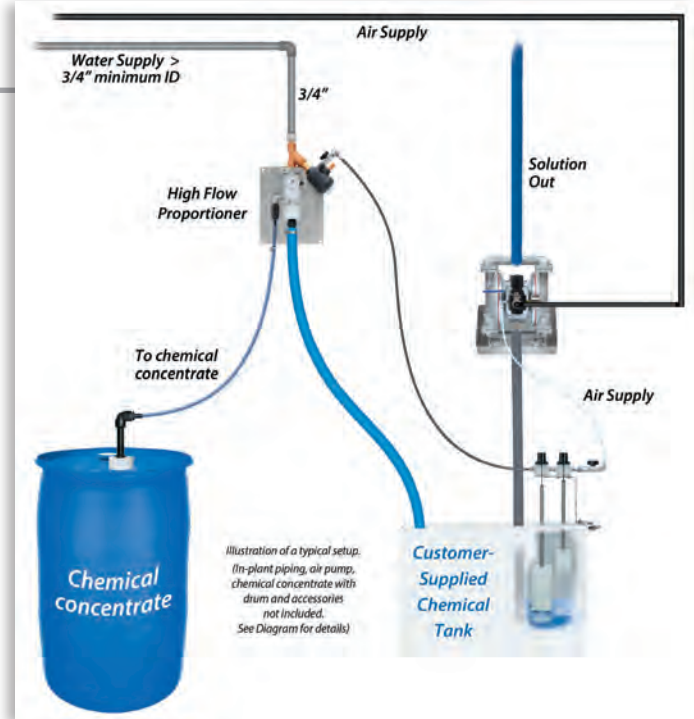

Model #	Description
989100	10 GPM High Flow Level Master™
989101	20 GPM High Flow Level Master™
989106	60/10 High Flow Level Master™
989108	60/20 High Flow Level Master™

▲ 10 GPM & 60/10 Level Master Systems include one High Flow Proportioner -- illustrated above.

▼ 20 GPM & 60/20 Level Master Systems include two High Flow Proportioners -- illustrated below.

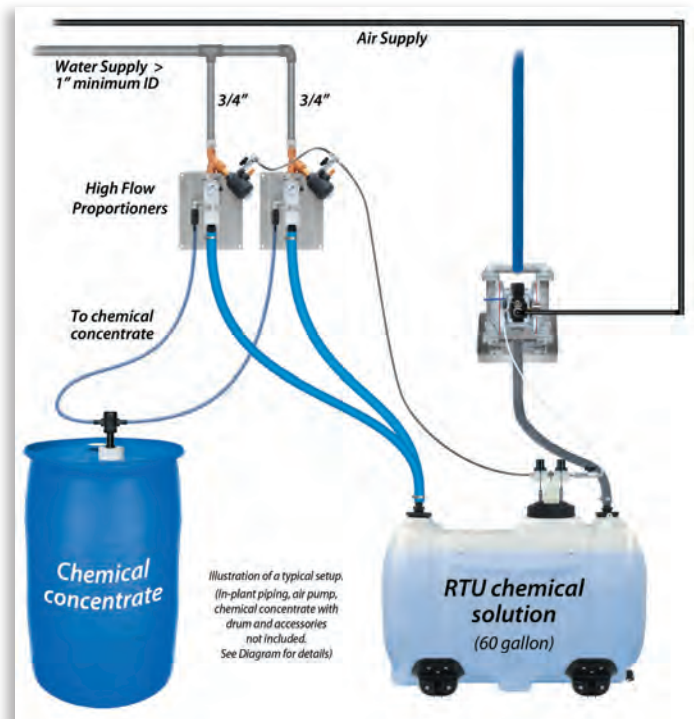



LAFFERTY GEMINI LEVEL MASTERS allow precise, independent dilution of two chemicals, with differing viscosities and dilution ratios, and are float-valve-operated proportioners, designed to quickly replenish and maintain the desired level of ready-to-use (RTU) chemical solution in any reservoir. The float valve triggers an air-activated solenoid to start and stop the flow of water through the high flow Gemini venturi proportioners. A secondary float valve provides fail-safe protection.

Available in two styles — bracket mount or lid mounted that are integrated with a tank lid to fit optional 7-gallon, 16-gallon, or 20-gallon tanks. **Gemini High Flow Level Master Systems** are available as integrated systems complete with 60-gallon tanks.

GEMINI LEVEL MASTER SYSTEMS

REQUIRES: 25-80 PSI WATER, COMPRESSED AIR AND TWO CHEMICAL CONCENTRATES

- Automatically maintains a pre-set level of ready-to-use chemical solution in a paired tank (*sold separately, see options*)
- The industry-leading Gemini™ proportioner dilutes two chemical concentrates and blends them downstream so that the concentrates never come into direct contact
- Designed to withstand demanding operating environments and the aggressive nature of chlorine dioxide
- Dual magnetic float valve design includes a primary valve to regulate normal operation and a secondary fail-safe valve to shut off the system if the primary float valve malfunctions
- Unsinkable solid polypropylene floats suspended by rigid "push rods" ensure smooth operation and prevent the float valves from sticking in the open position
- Downstream check valve prevents back-flow of liquid or vapor into the float valves to eliminate the potential for damage to internal mechanisms

Two styles

- Systems with heavy-duty stainless steel bracket for open tanks
SS Bracket clamps to the wall of an open tank
SSHM Bracket – horizontal mount – bolts to the top of a user-supplied tank
- Systems integrated into a tank lid designed to fit a 7-gallon, 16-gallon or 20-gallon tank (*also can be fitted to an optional 60-gallon tank*)

REQUIREMENTS / SPECIFICATIONS

Water Pressure	25 - 80 PSI	1.7 - 5.5 bar
Water Flow Rate	@ 40 PSI	@ 2.8 bar
	2.4 gpm	9.1 lpm

Includes

- Water supply inlet strainer
- Water supply shut-off ball valve
- Machined polypropylene Gemini™ injector body
- Two machined magnetic float valves (primary and fail-safe) with solid polypropylene floats suspended by rigid CPVC push rods
- Stainless steel / Viton back-flow prevention check valve
- Color-coded metering tips (20) to dilution ratios
- Metering tip driver
- Stainless steel bracket or plastic lid for a paired tank as indicated by model number (*Paired tank not included.*)

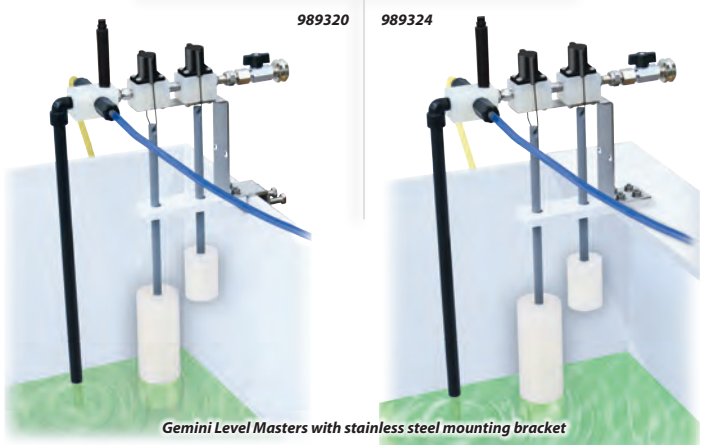
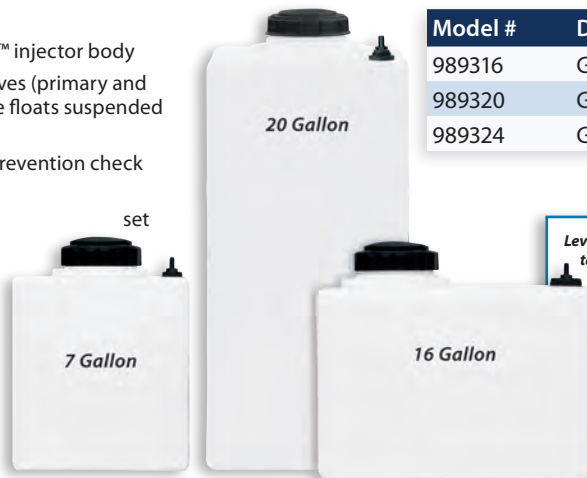

Model #	Description
989316	Gemini Level Master™ (No Tank)
989320	Gemini Level Master™ with SS Bracket
989324	Gemini Level Master™ with SSHM Bracket

Level Master™ Tanks are heavy-duty HDPE tanks designed for use with a Level Master lid assembly (sold separately). Each tank includes inlet and discharge assemblies with hose barbs.

Level Master Tank Sizes (Specify When Ordering)

7 Gallon	# 709170
16 Gallon	# 709171
20 Gallon	# 709172

GEMINI HIGH FLOW LEVEL MASTER SYSTEMS

REQUIRES: 35-125 PSI WATER, COMPRESSED AIR, TWO CHEMICAL CONCENTRATES

- Automatically maintains a pre-set level of ready-to-use chemical solution in a customer supplied tank
- The unique Gemini™ proportioner draws 2 chemical concentrates and blends them downstream after dilution
- Dilution ratios are controlled independently for each chemical using precision metering tips
- Dual magnetic float valve design includes a primary valve to regulate normal operation and a secondary fail-safe valve to shut off the system if the primary float valve malfunctions
- Unsinkable solid polypropylene floats suspended by rigid "push rods" ensure smooth operation and prevent the float valves from sticking in the open position
- Chemical resistant wetted components ensure years of outstanding performance with minimal maintenance
- Industrial-strength design holds up in tough environments
- Complete with hook-up connections for a compressed air-operated Lafferty Pumping System (or a user-supplied pumping system)
- Choice of two flow rates. Replenishes RTU solution at:
 - 7.0 gpm @ 40 PSI – 989072; 989126
(Includes a single Gemini high flow venturi proportioner)
 - 14.0 gpm @ 40 PSI – 989074; 989128
(Includes two Gemini high flow venturi proportioners)

Two styles

- Systems with heavy-duty stainless steel bracket for open tanks
 - SS Bracket clamps to the wall of an open tank
 - SSHM Bracket – horizontal mount – bolts to the top of a user-supplied tank
- Systems integrated with the lid of the included 60-gallon tank

REQUIREMENTS / SPECIFICATIONS

Compressed Air	<1 cfm	<28.3 lpm
Water Pressure	35 - 125 PSI	2.4 - 8.6 bar
Water Flow Rate	@ 40 PSI	@ 2.8 bar
989072; 989126	7.0 gpm	26.5 lpm
989076; 989128	14.0 gpm	53.0 lpm

Includes

- Stainless steel Level Master mounting bracket (989072; 989074) or 60-gallon high density polyethylene (HDPE) chemical tank with drain (989126; 989128)
- Two magnetic float valves (primary and fail-safe) with solid polypropylene floats suspended by rigid CPVC push rods
- Air inlet ball valve
- Two machined polypropylene Gemini™ injector bodies
- Stainless steel Satellite Mixing Station mounting plates
- Air-activated water solenoids
- Two sets, per Mixing Station, of 20 color-coded precision metering tips
- Metering tip driver with each set of metering tips

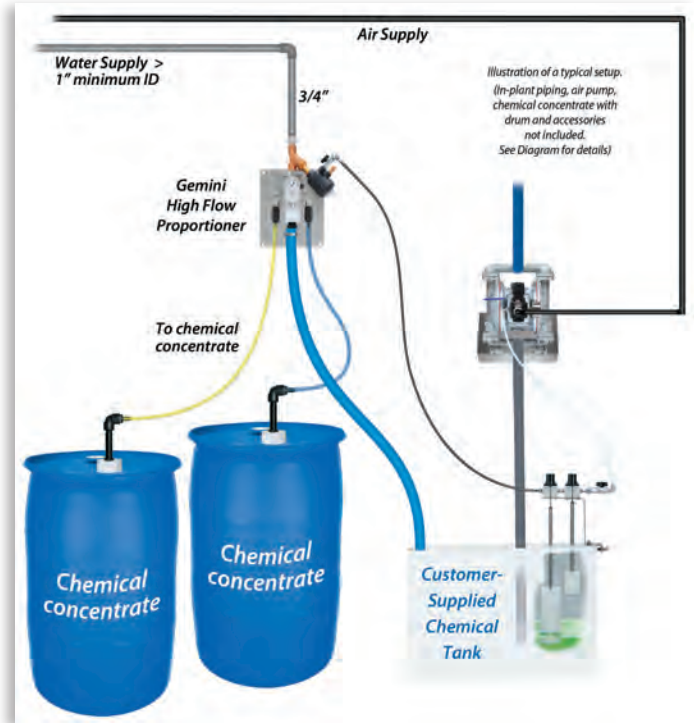

Model #	Description
989072	7 GPM Gemini High Flow Level Master™
989074	14 GPM Gemini High Flow Level Master™
989126	60/7 Gemini High Flow Level Master™
989128	60/14 Gemini High Flow Level Master™

▲ Illustrated above, 7 GPM & 60/7 Gemini High Flow Level Master Systems include one High Flow Proportioner.

▼ Illustrated below, 4 GPM & 60/14 Level Master Systems include two High Flow Proportioners.

